

PS-756 USER MANUAL

SPECIFICATION

- ▶ **Shell Material:** AL6061
- ▶ **Weight:** 4g
- ▶ **Dimension:** 21*15*8.8mm
- ▶ **Operating Voltage:** 3.7 ~ 8.4V
- ▶ **Dual Gain Mode:** Normal / Sensitive Mode
- ▶ **Input & Output Plug:** JST1.5mm(attached the signal input cable to connect with receiver)
- ▶ **Current Drain:** 20mA/6V
- ▶ **Operating temperature:** -10℃+50℃
- ▶ **Control System:** PID Control System
- ▶ **Input Signal:** PWM (50-333Hz) / SANWA SHR; SSR / FUTABA S.BUS
- ▶ **Output Signal:** 1520uS (50Hz/333Hz) / SANWA SSR

CONNECTION DIAGRAM

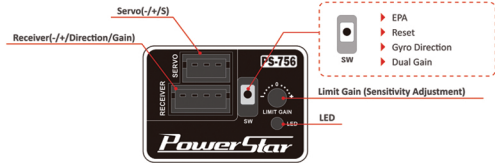

LED STATUS

LED	Status	Gain Adjustment Method
Red Fast Flash	Initialization	/
Orange Fast Flash	Loss of Control Signal	/
Yellow-green Solid Light	Normal Gain Mode	Gain Signal Input
Yellow-green Slow Flash	Normal Gain Mode	Potentiometer Adjustment
Red Solid Light	Sensitive Gain Mode	Gain Signal Input
Red Slow Flash 3 Times	Normal/Sensitive Mode Set	/
Orange Slow Flash 3 Times	Forward and Reverse Gain Set	/
Orange Slow Flash	Travel Set Mode	/

FUNCTION INSTRUCTION OF SWITCH

- ▶ **EPA (Travel Setting)**
Press the switch to power on, orange slow flash, enter into servo travel set mode, rotate the remote control steering to make the servo stop at the required position(to left or to right). Short press the switch, orange light fast flash 2 times, red solid light, then yellow-green slow flash, it means current travel has been saved. Rotate the remote con-

trol steering again to make the servo stop at another required position, short press the switch, orange light fast flash 2 times, then solid light, it means current travel has been saved as well. After 2 seconds gyro enter into initialization automatically, once completed, gyro is ready for use.

- ▶ **Reset (Travel Restore Default Setting)**
Press the switch to power on to travel set mode, hold press switch 3 seconds, red light and yellow-green flash alternately. Restore to default after 2 seconds. Then enter into initialization, once the initialization process has been completed, the gyro is ready for use.
- ▶ **Gyro Direction (Forward and Reverse Gain Setting)**
In the normal working state, hold press switch 4 seconds, orange light slow flash 3 times, reverse gain direction.
- ▶ **Dual Gain Mode Set**
In the normal working state, fast press switch 2 times, red slow flash 3 times, change normal mode/sensitive mode.

RECEIVER CONNECTION (INPUT SINGAL MODE)

- ▶ PWM (50-333Hz) suitable for most remote control systems, while plug-in the gain wire, it can adjust the sensitivity by transmitter(See PIC 1); While do not plug-in the gain wire, it can adjust the sensitivity by the potentiometer of gyro itself (See PIC 2).
- ▶ FUTABA S.BUS suitable for FUTABA S.BUS control systems. When use S.BUS signal input, default CH3 channel for sensitivity adjustment, and the gain wire is not used.
- ▶ SANWA SSR/SANWA SHR suitable for SANWA control system, when use SSR/SHR signal input, the output signal adapts to SSR/SHR signal automatically.

REMARK SAMWA SSR signal only for SSR servo, may cause permanent damage to the regular servo.

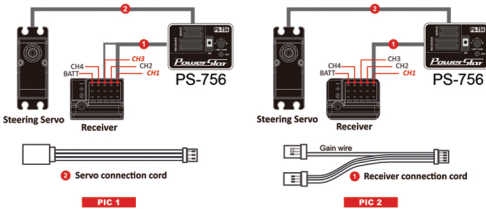

LIMIT GAIN (GAIN ADJUSTMENT)

- ▶ Through remote sensitivity channel to adjust sensitivity(by default when SBU input), the range is -100% ~ 0 ~ +100%.
- ▶ While not used gain wire to input, they gyro is in normal mode only, use potentiometer of gyro to adjust sensitivity, yellow-green slow flash.

NOTE Due to the gyro is very small, the adjustment trimmer is also a small part, please operate the trimmer with the accessory mini trimming tool and without applying unreasonable force.

PS-756 USER MANUAL

SPECIFICATION

- ▶ **Shell Material:** AL6061
- ▶ **Weight:** 4g
- ▶ **Dimension:** 21*15*8.8mm
- ▶ **Operating Voltage:** 3.7 ~ 8.4V
- ▶ **Dual Gain Mode:** Normal / Sensitive Mode
- ▶ **Input & Output Plug:** JST1.5mm(attached the signal input cable to connect with receiver)
- ▶ **Current Drain:** 20mA/6V
- ▶ **Operating temperature:** -10℃+50℃
- ▶ **Control System:** PID Control System
- ▶ **Input Signal:** PWM (50-333Hz) / SANWA SHR; SSR / FUTABA S.BUS
- ▶ **Output Signal:** 1520uS (50Hz/333Hz) / SANWA SSR

CONNECTION DIAGRAM

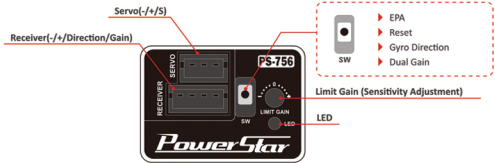

LED STATUS

LED	Status	Gain Adjustment Method
Red Fast Flash	Initialization	/
Orange Fast Flash	Loss of Control Signal	/
Yellow-green Solid Light	Normal Gain Mode	Gain Signal Input
Yellow-green Slow Flash	Normal Gain Mode	Potentiometer Adjustment
Red Solid Light	Sensitive Gain Mode	Gain Signal Input
Red Slow Flash 3 Times	Normal/Sensitive Mode Set	/
Orange Slow Flash 3 Times	Forward and Reverse Gain Set	/
Orange Slow Flash	Travel Set Mode	/

FUNCTION INSTRUCTION OF SWITCH

- ▶ **EPA (Travel Setting)**
Press the switch to power on, orange slow flash, enter into servo travel set mode, rotate the remote control steering to make the servo stop at the required position(to left or to right). Short press the switch, orange light fast flash 2 times, red solid light, then yellow-green slow flash, it means current travel has been saved. Rotate the remote con-

trol steering again to make the servo stop at another required position, short press the switch, orange light fast flash 2 times, then solid light, it means current travel has been saved as well. After 2 seconds gyro enter into initialization automatically, once completed, gyro is ready for use.

- ▶ **Reset (Travel Restore Default Setting)**
Press the switch to power on to travel set mode, hold press switch 3 seconds, red light and yellow-green flash alternately. Restore to default after 2 seconds. Then enter into initialization, once the initialization process has been completed, the gyro is ready for use.
- ▶ **Gyro Direction (Forward and Reverse Gain Setting)**
In the normal working state, hold press switch 4 seconds, orange light slow flash 3 times, reverse gain direction.
- ▶ **Dual Gain Mode Set**
In the normal working state, fast press switch 2 times, red slow flash 3 times, change normal mode/sensitive mode.

RECEIVER CONNECTION (INPUT SINGAL MODE)

- ▶ PWM (50-333Hz) suitable for most remote control systems, while plug-in the gain wire, it can adjust the sensitivity by transmitter(See PIC 1); While do not plug-in the gain wire, it can adjust the sensitivity by the potentiometer of gyro itself (See PIC 2).
- ▶ FUTABA S.BUS suitable for FUTABA S.BUS control systems. When use S.BUS signal input, default CH3 channel for sensitivity adjustment, and the gain wire is not used.
- ▶ SANWA SSR/SANWA SHR suitable for SANWA control system, when use SSR/SHR signal input, the output signal adapts to SSR/SHR signal automatically.

REMARK SAMWA SSR signal only for SSR servo, may cause permanent damage to the regular servo.

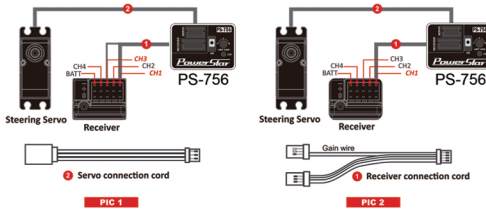

LIMIT GAIN (GAIN ADJUSTMENT)

- ▶ Through remote sensitivity channel to adjust sensitivity(by default when SBU input), the range is -100% ~ 0 ~ +100%.
- ▶ While not used gain wire to input, they gyro is in normal mode only, use potentiometer of gyro to adjust sensitivity, yellow-green slow flash.

NOTE Due to the gyro is very small, the adjustment trimmer is also a small part, please operate the trimmer with the accessory mini trimming tool and without applying unreasonable force.

PS-756 USER MANUAL

SPECIFICATION

- ▶ **Shell Material:** AL6061
- ▶ **Weight:** 4g
- ▶ **Dimension:** 21*15*8.8mm
- ▶ **Operating Voltage:** 3.7 ~ 8.4V
- ▶ **Dual Gain Mode:** Normal / Sensitive Mode
- ▶ **Input & Output Plug:** JST1.5mm(attached the signal input cable to connect with receiver)
- ▶ **Current Drain:** 20mA/6V
- ▶ **Operating temperature:** -10℃+50℃
- ▶ **Control System:** PID Control System
- ▶ **Input Signal:** PWM (50-333Hz) / SANWA SHR; SSR / FUTABA S.BUS
- ▶ **Output Signal:** 1520uS (50Hz/333Hz) / SANWA SSR

CONNECTION DIAGRAM

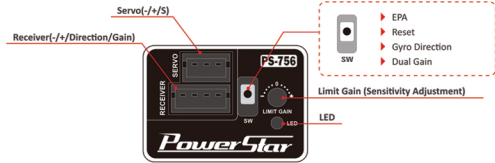

LED STATUS

LED	Status	Gain Adjustment Method
Red Fast Flash	Initialization	/
Orange Fast Flash	Loss of Control Signal	/
Yellow-green Solid Light	Normal Gain Mode	Gain Signal Input
Yellow-green Slow Flash	Normal Gain Mode	Potentiometer Adjustment
Red Solid Light	Sensitive Gain Mode	Gain Signal Input
Red Slow Flash 3 Times	Normal/Sensitive Mode Set	/
Orange Slow Flash 3 Times	Forward and Reverse Gain Set	/
Orange Slow Flash	Travel Set Mode	/

FUNCTION INSTRUCTION OF SWITCH

- ▶ **EPA (Travel Setting)**
Press the switch to power on, orange slow flash, enter into servo travel set mode, rotate the remote control steering to make the servo stop at the required position(to left or to right). Short press the switch, orange light fast flash 2 times, red solid light, then yellow-green slow flash, it means current travel has been saved. Rotate the remote con-

trol steering again to make the servo stop at another required position, short press the switch, orange light fast flash 2 times, then solid light, it means current travel has been saved as well. After 2 seconds gyro enter into initialization automatically, once completed, gyro is ready for use.

- ▶ **Reset (Travel Restore Default Setting)**
Press the switch to power on to travel set mode, hold press switch 3 seconds, red light and yellow-green flash alternately. Restore to default after 2 seconds. Then enter into initialization, once the initialization process has been completed, the gyro is ready for use.
- ▶ **Gyro Direction (Forward and Reverse Gain Setting)**
In the normal working state, hold press switch 4 seconds, orange light slow flash 3 times, reverse gain direction.
- ▶ **Dual Gain Mode Set**
In the normal working state, fast press switch 2 times, red slow flash 3 times, change normal mode/sensitive mode.

RECEIVER CONNECTION (INPUT SINGAL MODE)

- ▶ PWM (50-333Hz) suitable for most remote control systems, while plug-in the gain wire, it can adjust the sensitivity by transmitter(See PIC 1); While do not plug-in the gain wire, it can adjust the sensitivity by the potentiometer of gyro itself (See PIC 2).
- ▶ FUTABA S.BUS suitable for FUTABA S.BUS control systems. When use S.BUS signal input, default CH3 channel for sensitivity adjustment, and the gain wire is not used.
- ▶ SANWA SSR/SANWA SHR suitable for SANWA control system, when use SSR/SHR signal input, the output signal adapts to SSR/SHR signal automatically.

REMARK SAMWA SSR signal only for SSR servo, may cause permanent damage to the regular servo.

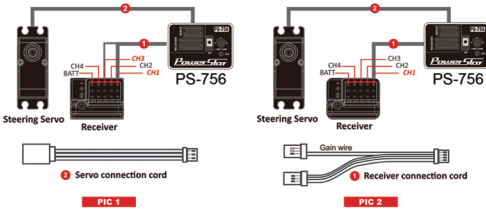

LIMIT GAIN (GAIN ADJUSTMENT)

- ▶ Through remote sensitivity channel to adjust sensitivity(by default when SBU input), the range is -100% ~ 0 ~ +100%.
- ▶ While not used gain wire to input, they gyro is in normal mode only, use potentiometer of gyro to adjust sensitivity, yellow-green slow flash.

NOTE Due to the gyro is very small, the adjustment trimmer is also a small part, please operate the trimmer with the accessory mini trimming tool and without applying unreasonable force.

PS-756 USER MANUAL

SPECIFICATION

- ▶ **Shell Material:** AL6061
- ▶ **Weight:** 4g
- ▶ **Dimension:** 21*15*8.8mm
- ▶ **Operating Voltage:** 3.7 ~ 8.4V
- ▶ **Dual Gain Mode:** Normal / Sensitive Mode
- ▶ **Input & Output Plug:** JST1.5mm(attached the signal input cable to connect with receiver)
- ▶ **Current Drain:** 20mA/6V
- ▶ **Operating temperature:** -10℃+50℃
- ▶ **Control System:** PID Control System
- ▶ **Input Signal:** PWM (50-333Hz) / SANWA SHR; SSR / FUTABA S.BUS
- ▶ **Output Signal:** 1520uS (50Hz/333Hz) / SANWA SSR

CONNECTION DIAGRAM

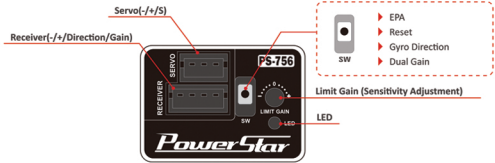

LED STATUS

LED	Status	Gain Adjustment Method
Red Fast Flash	Initialization	/
Orange Fast Flash	Loss of Control Signal	/
Yellow-green Solid Light	Normal Gain Mode	Gain Signal Input
Yellow-green Slow Flash	Normal Gain Mode	Potentiometer Adjustment
Red Solid Light	Sensitive Gain Mode	Gain Signal Input
Red Slow Flash 3 Times	Normal/Sensitive Mode Set	/
Orange Slow Flash 3 Times	Forward and Reverse Gain Set	/
Orange Slow Flash	Travel Set Mode	/

FUNCTION INSTRUCTION OF SWITCH

- ▶ **EPA (Travel Setting)**
Press the switch to power on, orange slow flash, enter into servo travel set mode, rotate the remote control steering to make the servo stop at the required position(to left or to right). Short press the switch, orange light fast flash 2 times, red solid light, then yellow-green slow flash, it means current travel has been saved. Rotate the remote con-

trol steering again to make the servo stop at another required position, short press the switch, orange light fast flash 2 times, then solid light, it means current travel has been saved as well. After 2 seconds gyro enter into initialization automatically, once completed, gyro is ready for use.

- ▶ **Reset (Travel Restore Default Setting)**
Press the switch to power on to travel set mode, hold press switch 3 seconds, red light and yellow-green flash alternately. Restore to default after 2 seconds. Then enter into initialization, once the initialization process has been completed, the gyro is ready for use.
- ▶ **Gyro Direction (Forward and Reverse Gain Setting)**
In the normal working state, hold press switch 4 seconds, orange light slow flash 3 times, reverse gain direction.
- ▶ **Dual Gain Mode Set**
In the normal working state, fast press switch 2 times, red slow flash 3 times, change normal mode/sensitive mode.

RECEIVER CONNECTION (INPUT SINGAL MODE)

- ▶ PWM (50-333Hz) suitable for most remote control systems, while plug-in the gain wire, it can adjust the sensitivity by transmitter(See PIC 1); While do not plug-in the gain wire, it can adjust the sensitivity by the potentiometer of gyro itself (See PIC 2).
- ▶ FUTABA S.BUS suitable for FUTABA S.BUS control systems. When use S.BUS signal input, default CH3 channel for sensitivity adjustment, and the gain wire is not used.
- ▶ SANWA SSR/SANWA SHR suitable for SANWA control system, when use SSR/SHR signal input, the output signal adapts to SSR/SHR signal automatically.

REMARK SAMWA SSR signal only for SSR servo, may cause permanent damage to the regular servo.

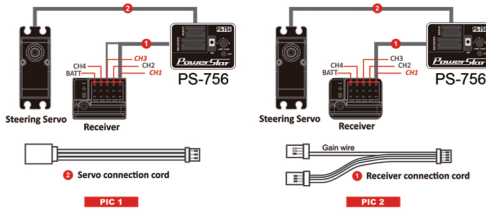

LIMIT GAIN (GAIN ADJUSTMENT)

- ▶ Through remote sensitivity channel to adjust sensitivity(by default when SBU input), the range is -100% ~ 0 ~ +100%.
- ▶ While not used gain wire to input, they gyro is in normal mode only, use potentiometer of gyro to adjust sensitivity, yellow-green slow flash.

NOTE Due to the gyro is very small, the adjustment trimmer is also a small part, please operate the trimmer with the accessory mini trimming tool and without applying unreasonable force.

